





**ZONING STATISTICS TABLE**

ITEM	REQ'D	PROV'D
Lot area m <sup>2</sup>	N.A.	14,255
Building area m <sup>2</sup>	45% max	2,420
Building coverage (%)	35% max of lot area	17.00%
Landscaped area m <sup>2</sup>	30% min of lot area	5,753
Landscaped area % age	30% min of lot area	40.40%
Paved area (asphalt) m <sup>2</sup>	N.A.	5,568
Paved area % age	N.A.	39%
Conc. Sidewalk m <sup>2</sup>	N.A.	514
# Parking spaces	1 per 16 m <sup>2</sup> of building	152
# Accessible	1 % of parking	2

**LEGEND**

-  FIRE HYDRANT AND VALVE
-  PAV'T MARKINGS 100mm WIDTH WHITE @ 300mm SPACING
-  FIRE ROUTE
-  TYPE OF TREE/SHRUB

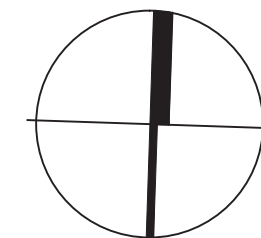
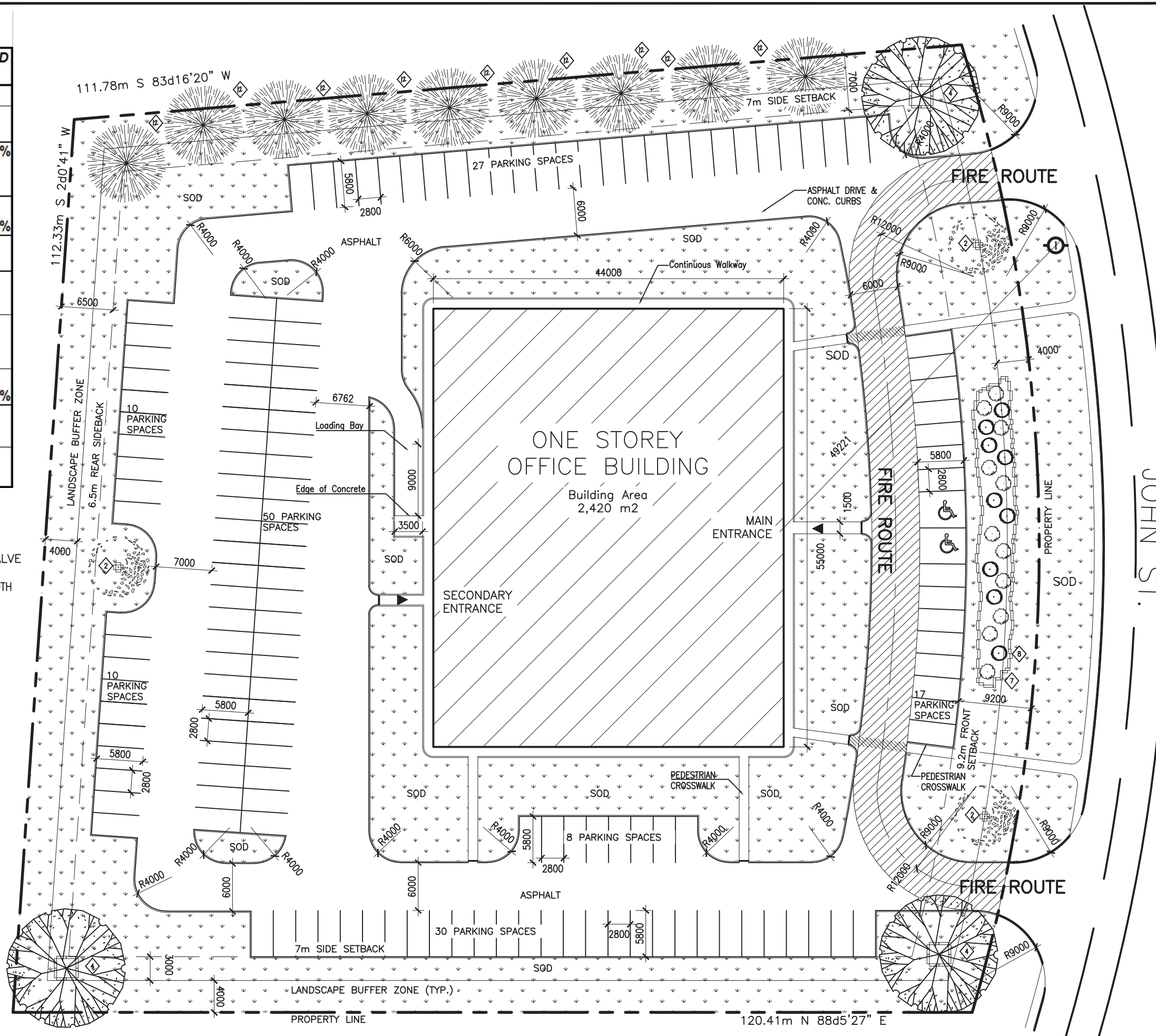

NORTH

NO.	DATE.	REVISION.
0	05/18/11	ISSUED FOR EVALUATION
0	05/16/11	ISSUED FOR CLIENT REVIEW



CLIENT  
**SUNRISE DEVELOPMENTS**  
 1364 KING STREET  
 HAMILTON, ONTARIO.

PROJECT  
**STONEY CREEK OFFICE PARK**  
 115 JOHN STREET  
 STONEY CREEK, ONTARIO

DRAWING TITLE  
**PROPOSED SITE PLAN**

SCALE  
**1:500**

DATE:  
**05.18.11**

DRAWN BY:  
**gonzdani**

PROJECT NO.

DWG. NO.

ASP-1